

ASSEMBLY MANUAL

PISA MIRROR

ASSEMBLY KIT

- Assembly Manual QR Code;
- Handling and Cleaning Manual;
- Phillips screw M 5.0x50mm;
- 58 wall plug for masonry.



STEP BY STEP HANGING

1. Remove the mounting bracket that comes with the piece and, using a tape measure, mark on the wall the point where the first hole will be drilled.

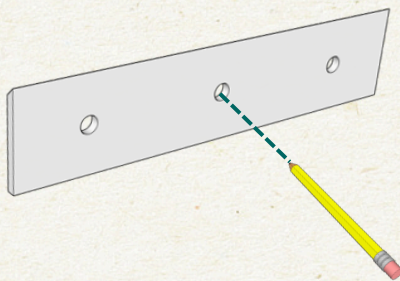

2. Drill a hole in the wall using a drill and insert the 8 mm 5 wall plug that comes with the installation kit. Screw the ruler in place with the beveled side facing up and the raw MDF finish facing the wall, as shown in the drawing below.

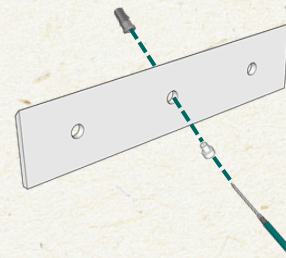

3. Using a level, mark the additional points on the wall, drill the holes, and finish attaching the ruler.

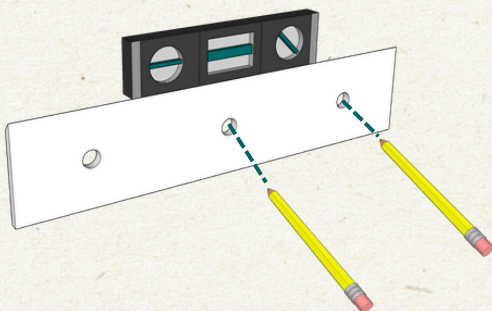

4. Carefully fit the mirror onto the mounting bracket, as shown in the figure below.

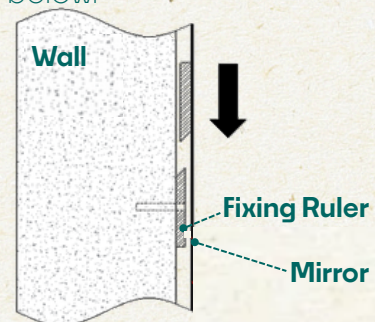

ASSEMBLY MANUAL

MIRROR PISA

ASSEMBLY KIT

- Assembly Manual QR Code;
- Handling and Cleaning Manual;
- Safety hook;
- 58 wall plug for masonry.
- Steel cable and closed hooks.



STEP BY STEP SUPPORTED

- 1.** Screw the closed hooks with the steel cable onto the panel.

Note: There is no need to remove the mounting brackets on the back of the panel.

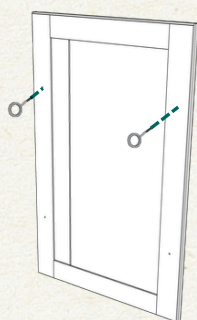

- 2.** Find the center and height measurements of the steel cable on the panel. Mark the position found previously on the wall.

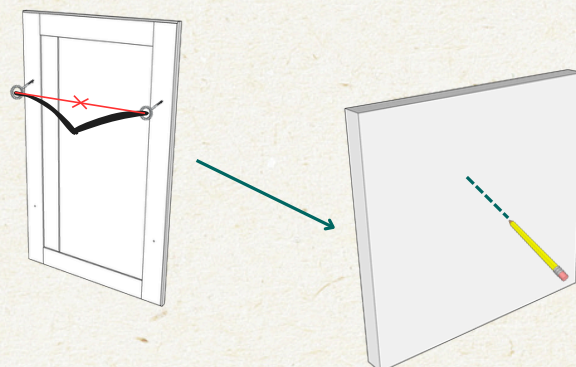

- 3.** Drill a hole in the wall using an 8mm drill bit. Then insert the 8mm wall plug into the hole and screw in the safety hook with the opening facing upwards.

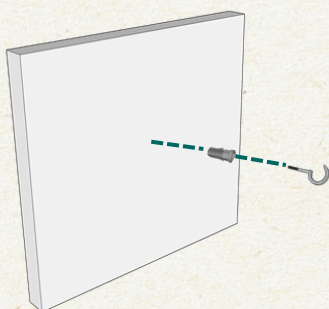

- 4.** Pass the steel cable through the open hook, positioning the panel 7 to 15 cm away from the wall at the bottom.

