

ASSEMBLY MANUAL

STONE MIRROR

ASSEMBLY KIT

- Assembly Manual QR Code;
- Handling and Cleaning Manual;
- Phillips screw M 5.0x50mm;
- 58 wall plug for masonry.



STEP BY STEP

- 1.** Remove the mounting bracket that comes with the piece and, using a tape measure, mark on the wall the point where the first hole will be drilled.

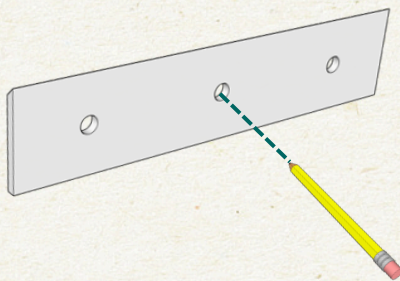

- 2.** Drill a hole in the wall using a drill and insert the 8 mm 5 wall plug that comes with the installation kit. Screw the ruler in place with the beveled side facing up and the raw MDF finish facing the wall, as shown in the drawing below.

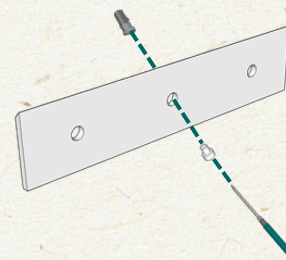

- 3.** Using a level, mark the additional points on the wall, drill the holes, and finish attaching the ruler.

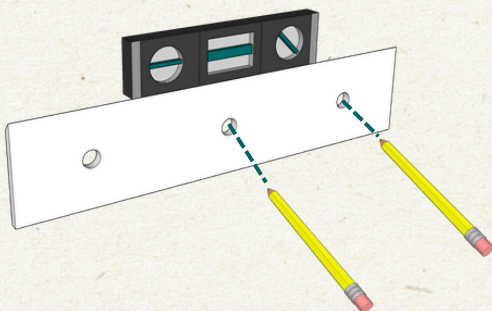

- 4.** Carefully fit the mirror onto the mounting bracket, as shown in the figure below.

